

DAMAAN CITY

Area (627 Sq ft)

One Bedroom with attached Bath,
Kitchen, Living, O.T.S & Porch.

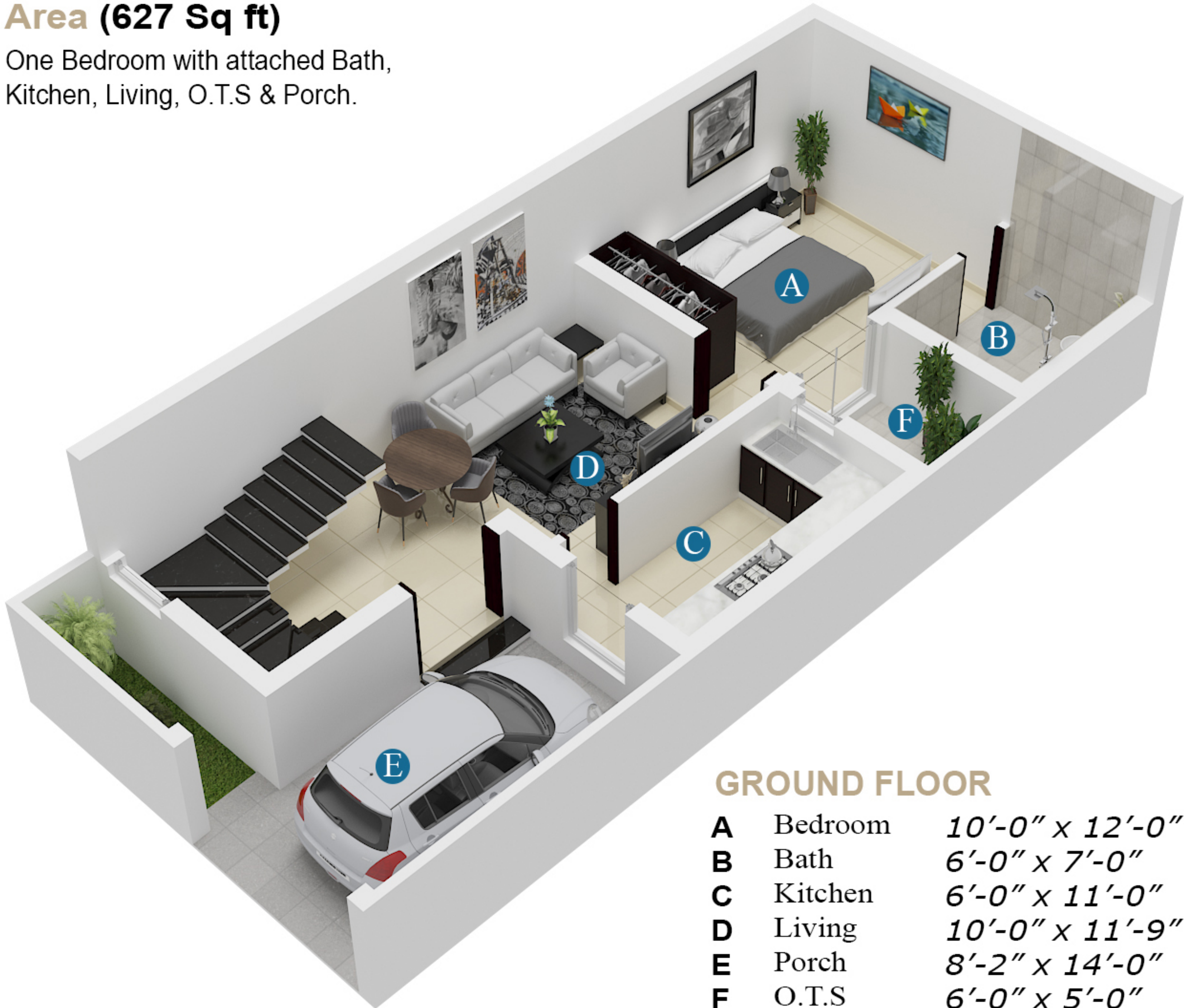

GROUND FLOOR

A	Bedroom	10'-0" x 12'-0"
B	Bath	6'-0" x 7'-0"
C	Kitchen	6'-0" x 11'-0"
D	Living	10'-0" x 11'-9"
E	Porch	8'-2" x 14'-0"
F	O.T.S	6'-0" x 5'-0"

DAMAAN CITY

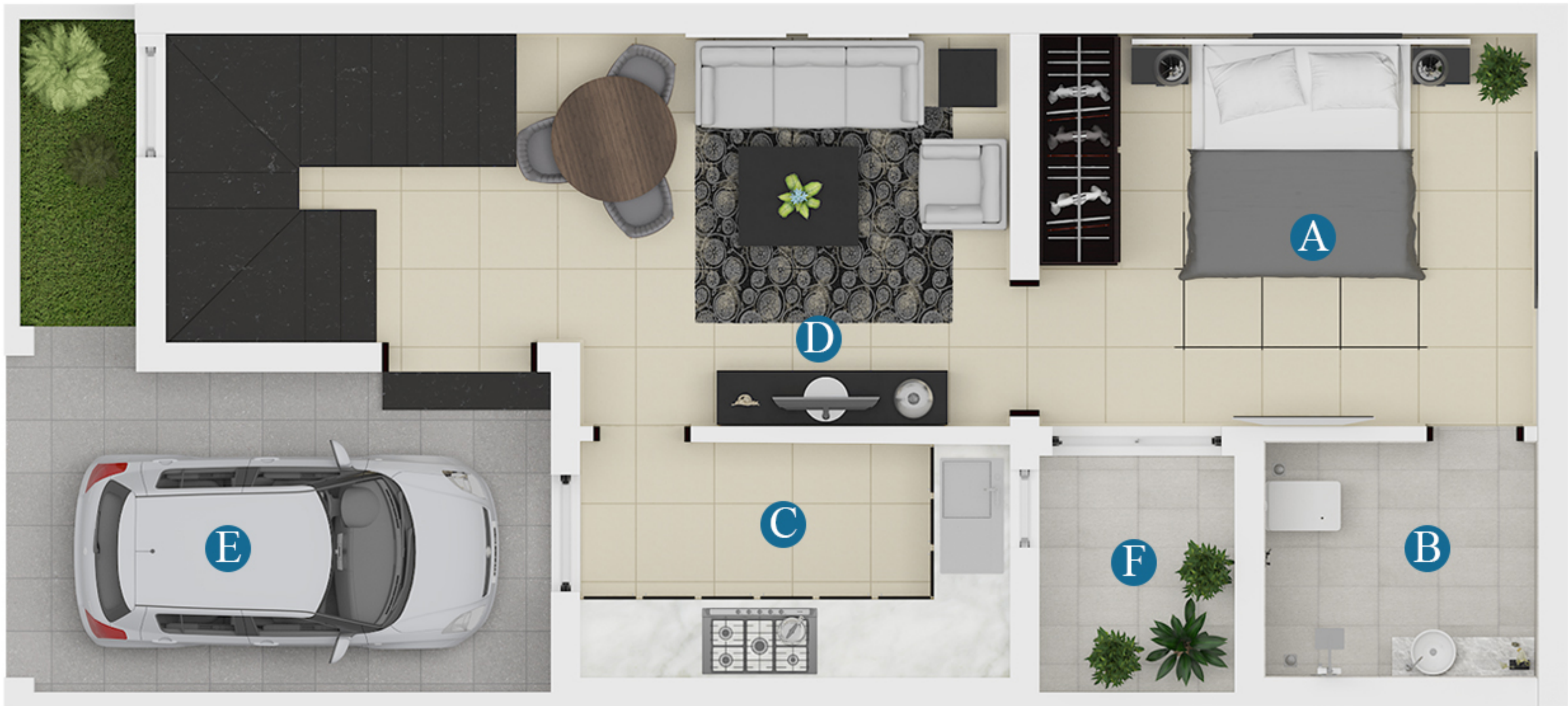

Area (627 Sq ft)

One Bedroom with attached Bath,
Kitchen, Living, O.T.S & Porch.

GROUND FLOOR

A	Bedroom	10'-0" x 12'-0"
B	Bath	6'-0" x 7'-0"
C	Kitchen	6'-0" x 11'-0"
D	Living	10'-0" x 11'-9"
E	Porch	8'-2" x 14'-0"
F	O.T.S	6'-0" x 5'-0"

DAMAAN CITY

Area (627 Sq ft)

Two Bedrooms with attached Bath,
& Terrace.



FIRST FLOOR

A	Bedroom	10'-0" x 15'-0"
B	Bath	6'-0" x 7'-0"
C	Bedroom	12'-7" x 14'-3"
D	Bath	6'-0" x 7'-0"
E	Terrace	6'-10" x 3'-4½"

DAMAAN CITY



Area (627 Sq ft)

Two Bedrooms with attached Bath,
& Terrace.

FIRST FLOOR

A	Bedroom	10'-0" x 15'-0"
B	Bath	6'-0" x 7'-0"
C	Bedroom	12'-7" x 14'-3"
D	Bath	6'-0" x 7'-0"
E	Terrace	6'-10" x 3'-4½"